

Standard Ladderack Package *Fitting to Citroen Berlingo and Peugeot Partner*

LRP-010

PLEASE NOTE: EXTRUDED SKIS (1 & 2) ARE IDENTICAL AND CAN BE USED EITHER SIDE OF THE SKI UNIT ASSEMBLY

699-0521-01

1 - RIGHT-HAND EXTRUDED SKI - x1

PART No: A802-0095-M

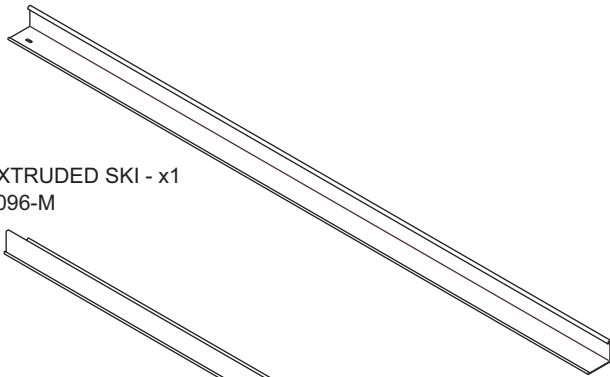

2 - LEFT-HAND EXTRUDED SKI - x1

PART No: A802-0096-M

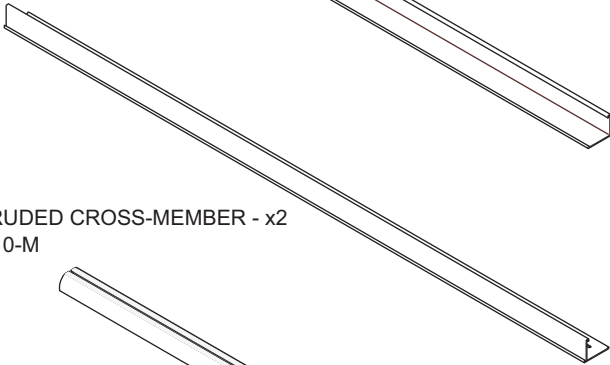

3 - 1250mm EXTRUDED CROSS-MEMBER - x2

PART No: 802-0110-M



4 - PVC FLEXIBLE STRIP 2.5

PART No: 525-0007

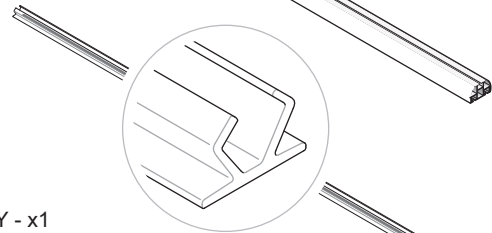

5 - TIE BAR ASSEMBLY - x1

PART No: 602-1273

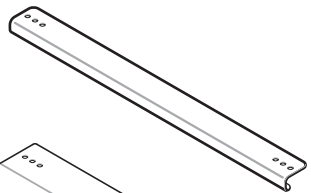

6 - REAR APRON PLATE - x1

PART No: 802-0118PECBAC

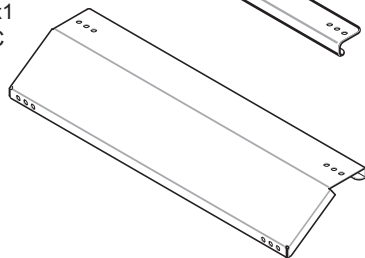

7 - LEFT-HAND FRONT FOOT BRACKET - x1

PART No: 702-1411-PCBAC

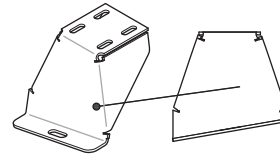

8 - RIGHT-HAND FRONT FOOT BRACKET - x1

PART No: 702-1412-PCBAC

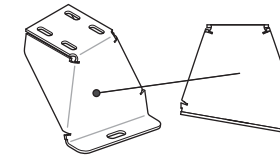

9 - REAR FOOT BRACKET - x2

PART No: 702-1414-PCBAC

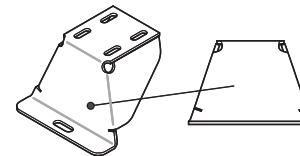

10 - SKI BUMPERS (PAIR) - x1

PART No: 802-0087

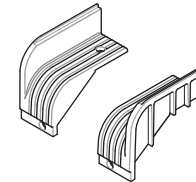

11 - INTERNAL CLAMP PAD - x6

PART No: 802-0097



12 - PLASTIC END CAP - x4

PART No: 802-0086

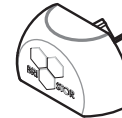

13 - 50mm NUT RETAINER - x8

PART No: 802-0098

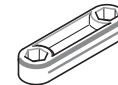

14 - 80mm NUT RETAINER - x4

PART No: 802-0099

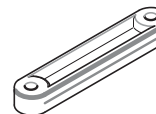

15 - OUTER CLAMP BLOCK - x4

PART No: 802-0090



16 - M6x20mm SET-SCREW, S.ST - x16

PART No: 307-06020S

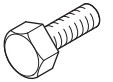

17 - M6x20mm A-KEY DOME BOLT, S.ST - x6

PART No: 311-06020S

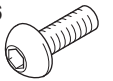

18 - M6x25mm A-KEY DOME BOLT, S.ST - x8

PART No: 311-06025S

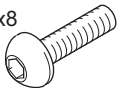

19 - M8x25mm SET-PIN, S.ST - x4

PART No: 307-08025S

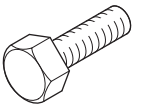

20 - M6 FORM 'C' WASHER, S.ST - x27

PART No: 301-0006CS



21 - M8 SPRING WASHER, S.ST - x4

PART No: 302-0008S



22 - M8 FORM 'C' WASHER, S.ST - x4

PART No: 301-0008CS



23 - M6 NYLOC NUT, S.ST - x30

PART No: 305-0006S



24 - ALLEN KEY - x1

PART No: 327-0003

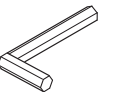

25 - FOOT PROTECTION PAD - x4

PART No: 812-0173



step 1

SLIDE AN INTERNAL CLAMP PAD INTO EACH EXTRUDED SKI CHANNEL.

MEASURE YOUR LADDER AND ALIGN EXTRUDED SKIS WITH FRONT TIE BAR TO THE SUITABLE MEASUREMENT AND SECURE.

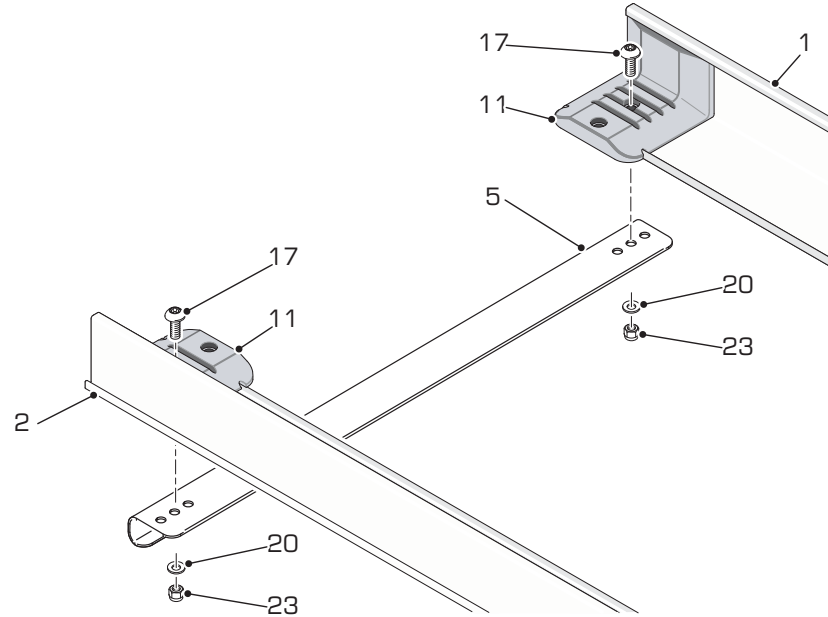
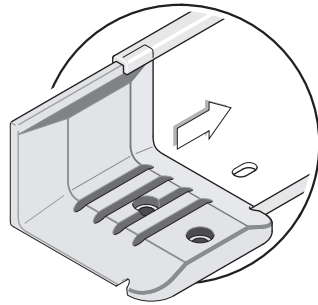

step 2

SLIDE SKI BUMPERS INTO EXTRUDED SKI CHANNEL AS SHOWN, ALIGN WITH REAR APRON PLATE AND LOOSELY ATTACH USING TYPICAL FIXING METHOD SHOWN.

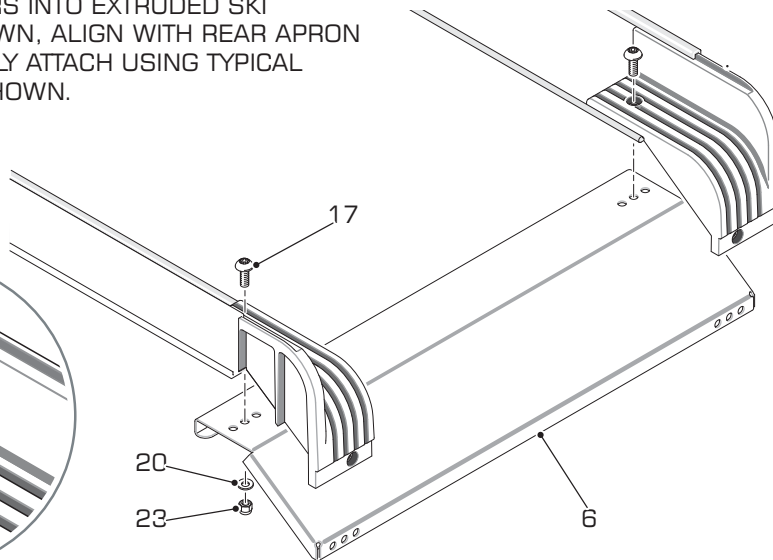
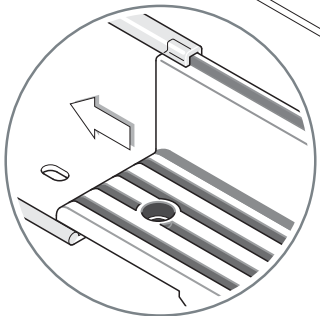

step 3

SECURE SKI BUMPERS ONTO REAR APRON PLATE USING FIXING METHOD. **AT THIS STAGE TIGHTEN ALL FASTENERS.**

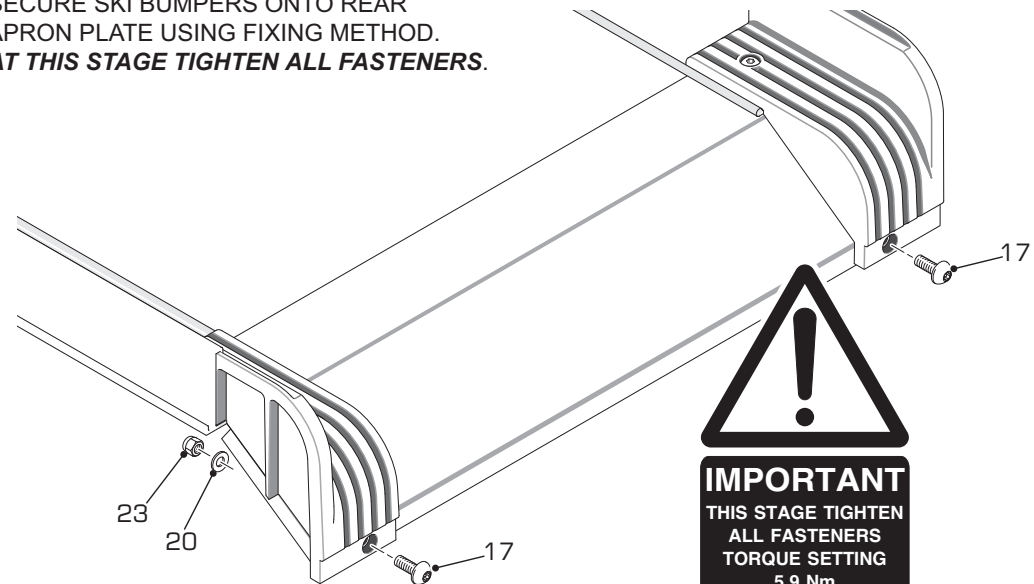

IMPORTANT
THIS STAGE TIGHTEN
ALL FASTENERS
TORQUE SETTING
5.9 Nm

step 4

LOCATE M6x20mm SET-PINS INTO ALL 50mm NUT RETAINERS AS SHOWN
LOOSELY ATTACH 50mm NUT RETAINERS AS SHOWN ONTO ALL FEET BRACKETS.



IMPORTANT
 LOOSELY ATTACH

IMPORTANT
 REPEAT FOR ALL FEET BRACKETS

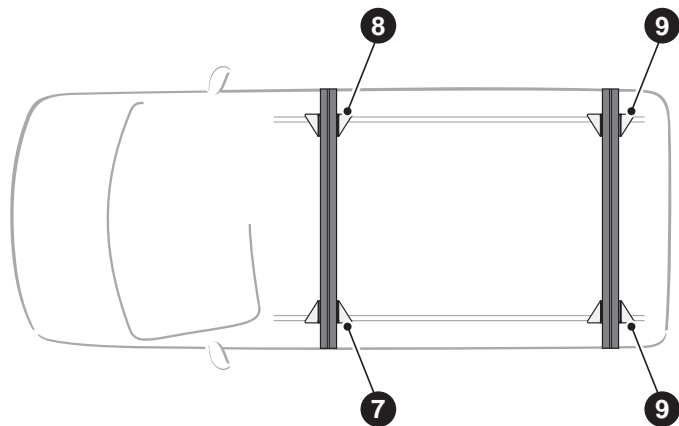
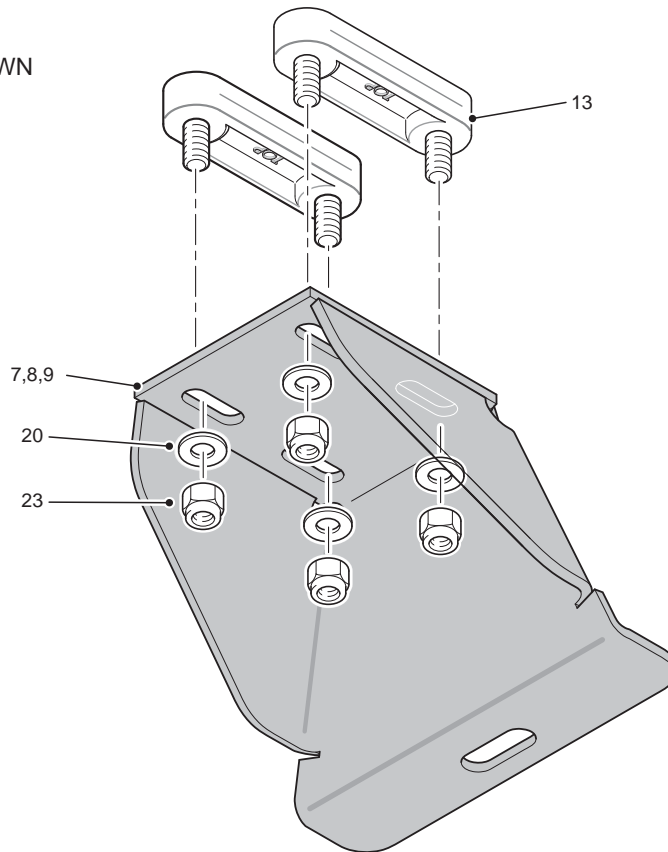
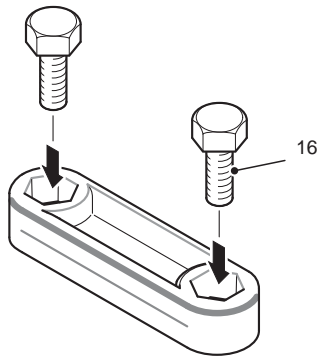

step 5

SLIDE EACH FRONT FOOT BRACKET ONTO CROSS-MEMBERS AS SHOWN STARTING WITH THE FRONT CROSS MEMBER.

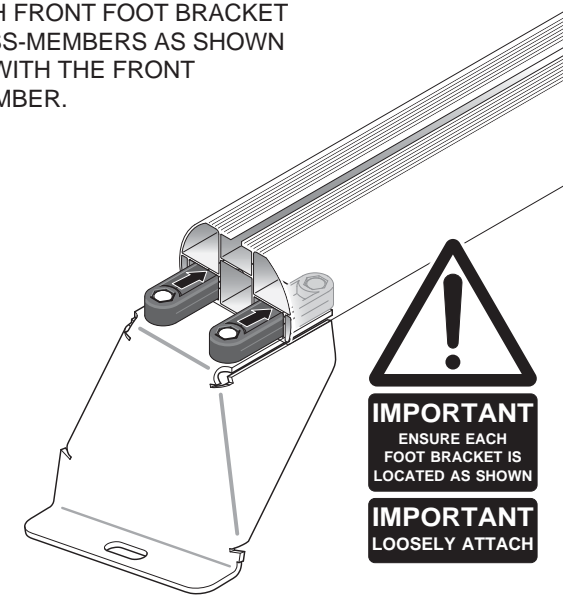

IMPORTANT
 ENSURE EACH FOOT BRACKET IS LOCATED AS SHOWN

IMPORTANT
 LOOSELY ATTACH

step 6

PLACE FOOT PROTECTION PADS OVER FIXING POINTS AND **LOOSELY ATTACH** CROSS-MEMBER ASSEMBLIES ONTO VEHICLE ROOF AT EXISTING FIXING POINTS.

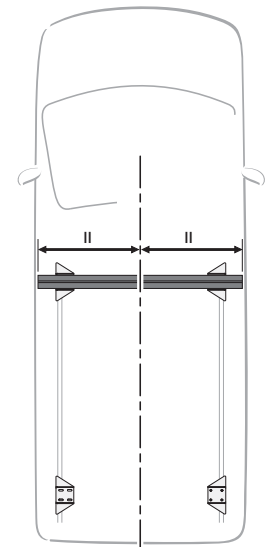
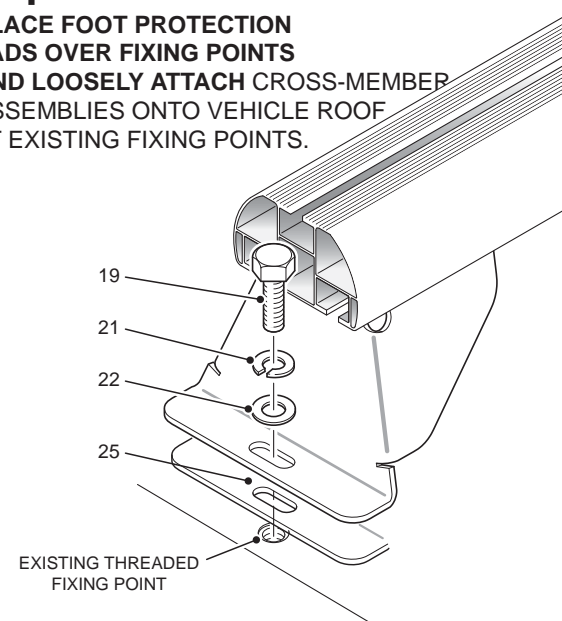

ENSURE EACH CROSS-MEMBER IS LOCATED CENTRALLY AND TIGHTEN ALL FASTENERS SET TORQUE TO 14.5 Nm.

step 7

ONCE ALUMINIUM CROSS-BARS ARE FITTED LOCATE M6 NYLOC NUTS INTO ALL 80mm NUT RETAINERS AS SHOWN.

INSERT **TWO** 80mm NUT RETAINERS INTO CROSS-MEMBER APERTURE SHOWN.



IMPORTANT
NOTE ORIENTATION OF M6 NYLOC NUT WHEN INSERTING INTO 80mm NUT RETAINER

IMPORTANT
NOTE ORIENTATION OF 80mm NUT RETAINERS WHEN INSERTING INTO CROSS-MEMBERS

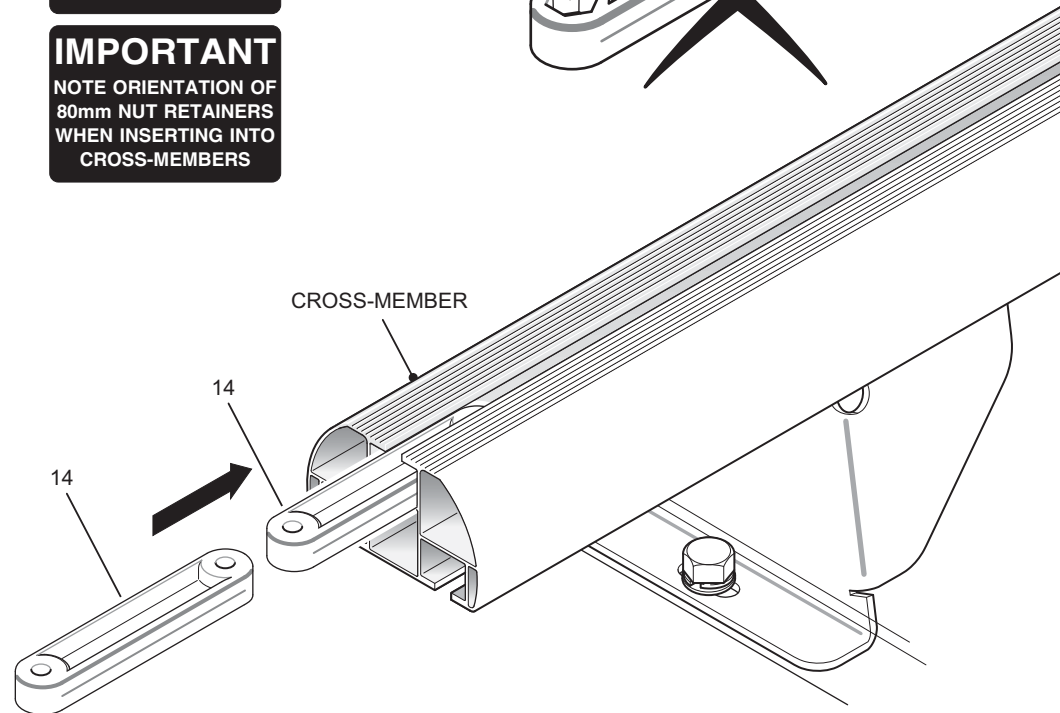
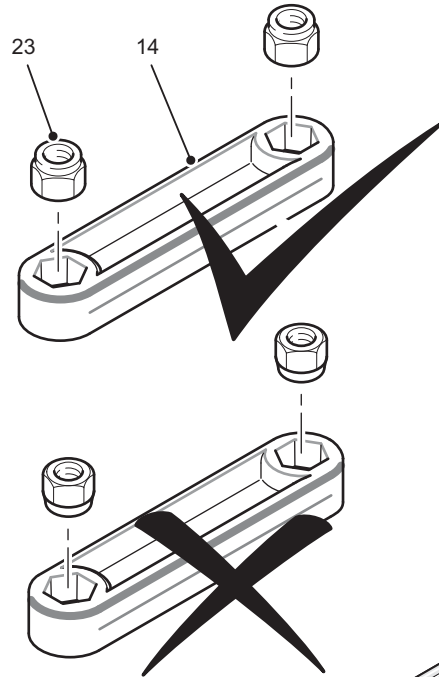

CARRY OUT THIS PROCEDURE AT FRONT AND REAR CROSS-MEMBERS

step 8

LOCATE FOUR INTERNAL CLAMP PADS IN APPROXIMATE POSITIONS SHOWN ABOVE.

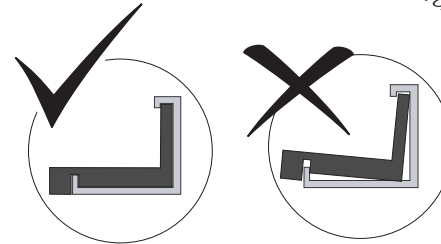
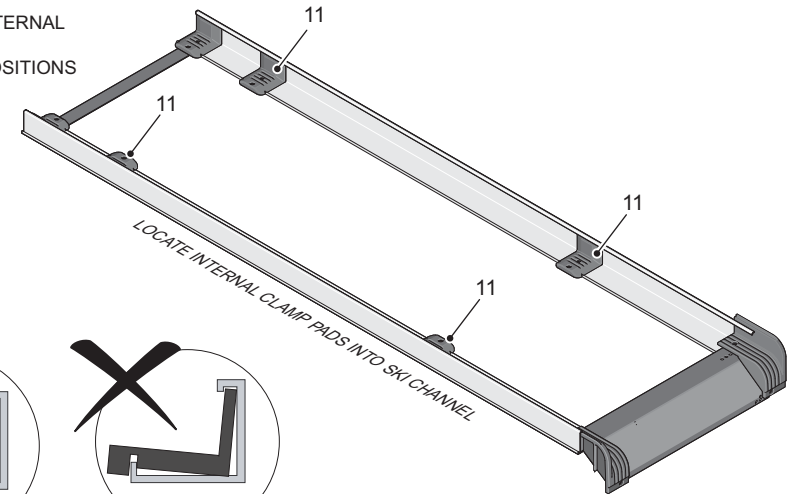

IMPORTANT: ENSURE INTERNAL CLAMP PADS ARE LOCATED WITHIN SKI CHANNELS.

step 9

LOCATE SKI UNIT ASSEMBLY ONTO CROSS-MEMBERS IN APPROXIMATE LOCATION SHOWN.

ALIGN 80mm NUT RETAINERS, FITTED PREVIOUSLY, WITH INTERNAL CLAMP PADS AND LOOSELY ATTACH.

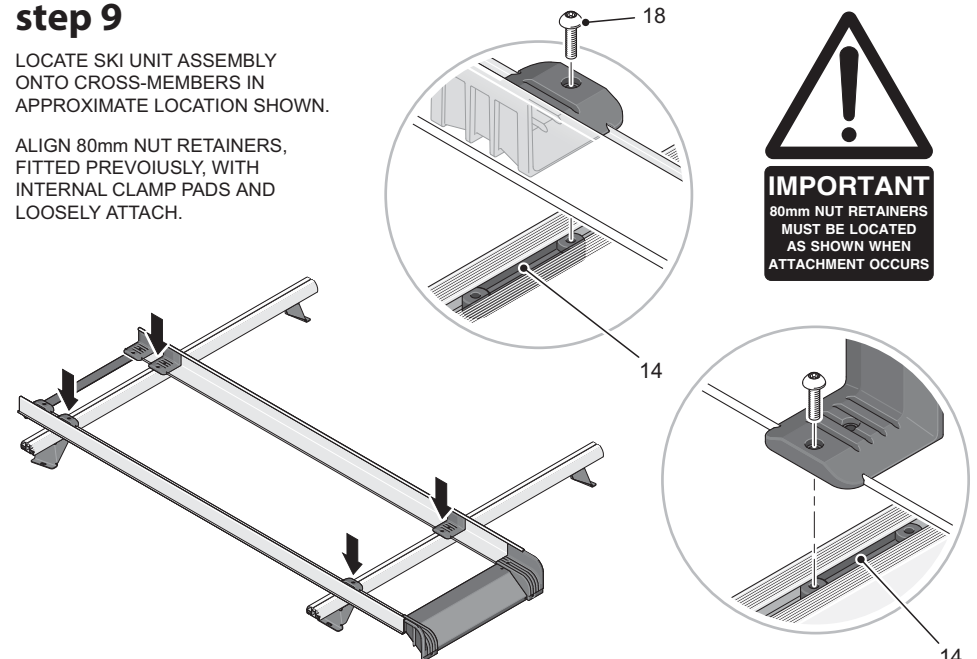

IMPORTANT
80mm NUT RETAINERS MUST BE LOCATED AS SHOWN WHEN ATTACHMENT OCCURS

step 10

LOCATE REAR APRON PLATE OF SKI UNIT LEVEL WITH REAR OF VEHICLE AS SHOWN.

SLIDE SKI UNIT ASSEMBLY INTO POSITION, DO NOT REMOVE ANY FASTENERS.

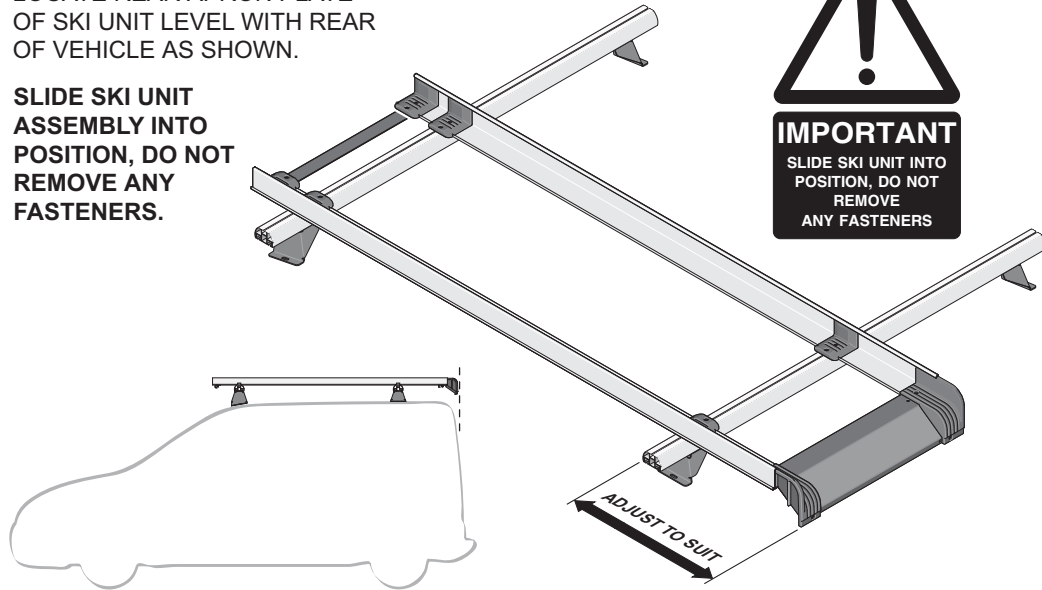

step 11

LOCATE SKI UNIT ASSEMBLY INTO DESIRED POSITION ACROSS WIDTH OF CROSS-MEMBERS AND LOOSELY ATTACH AS SHOWN. PLEASE BE AWARE OF VEHICLE AERIAL OR ANY OTHER OBSTRUCTIONS WHEN DETERMINING THIS POSITION.

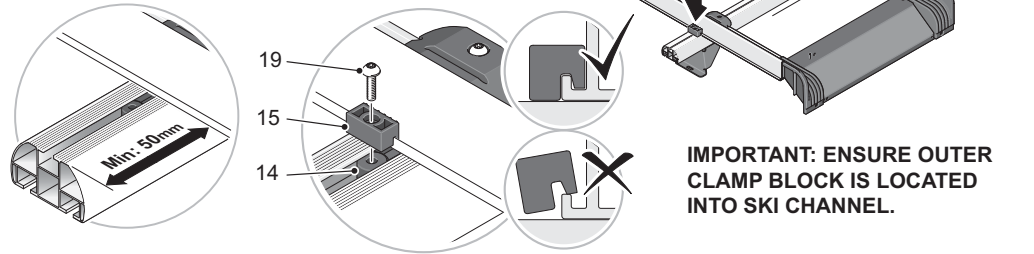

step 12

LOCATE A PLASTIC END CAP INTO EACH END OF CROSS-MEMBERS.

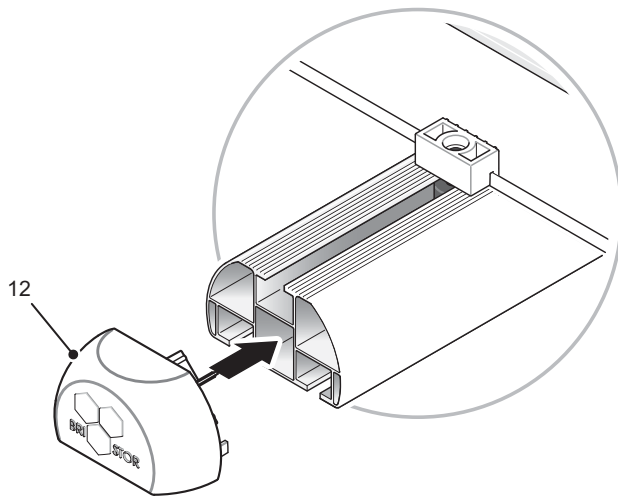

step 13

MEASURE DISTANCE A, B & C ON FRONT CROSS-MEMBER ASSEMBLY ONLY. CUT EACH PIECE OF FLEXIBLE STRIP TO MEASUREMENTS A, B & C.

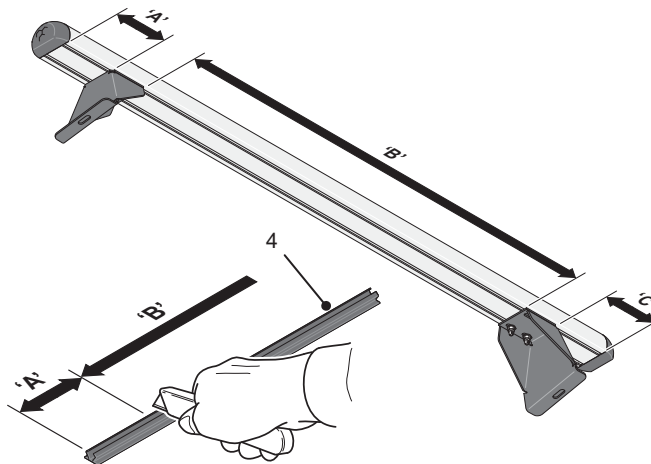

step 14

INSERT EACH PIECE OF FLEXIBLE STRIP INTO FRONT CROSS-MEMBER APERTURES AS SHOWN.

